

PART NAME	LARGE NON-METALLIC ENCLOSURE (STYLE A)	PART No.	NBA-10148 & NBA-10168
-----------	--	----------	-----------------------

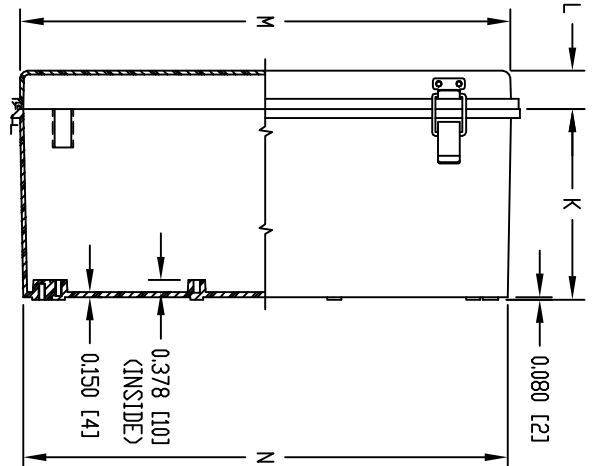
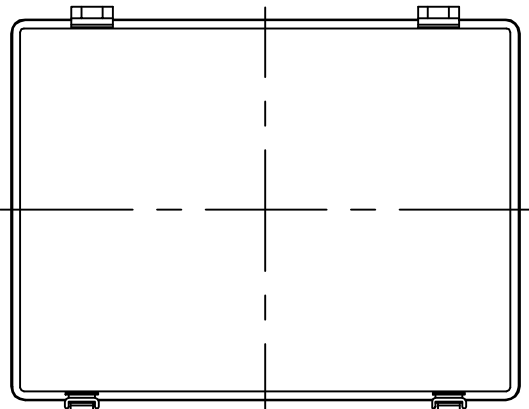
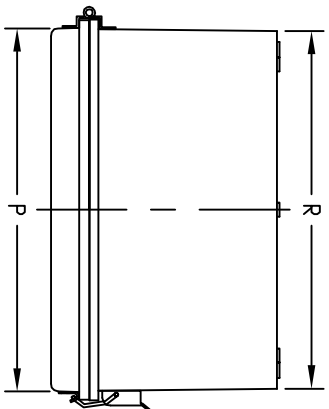

**MATERIAL:**  
 SOLID BODY & COVER — ABS/PC BLENDED PLASTIC  
 UL94-5VB FLAMMABILITY RATING  
 -40°C TO +70°C TEMPERATURE RANGE  
 CLEAR COVER — POLYCARBONATE PLASTIC  
 UL94-V0 FLAMMABILITY RATING  
 -40°C TO +70°C TEMPERATURE RANGE  
 UV STABILIZED

LATCHES, HINGES &  
 WALL MOUNTING BRACKETS — STAINLESS STEEL

**FINISH:**  
 BODY — LIGHT GRAY  
 COVER — LIGHT GRAY OR CLEAR

COVER IS GASKETED.

**NOTE:** UNIT COMES COMPLETE WITH FOUR (4) STAINLESS STEEL WALL MOUNTING BRACKETS. (NOT SHOWN)

INTERNAL HINGED PANEL MOUNTING BRACKETS, AIR & MOISTURE VENTS, STAINLESS STEEL LOCKING HASP AND GALVANIZED STEEL INTERNAL PANEL ARE NOT INCLUDED, BUT CAN BE PURCHASED SEPARATELY.

0.590 (15) DIA. BOSS WITH M5 x 0.8mm THREADED BRASS INSERT (4) PLACES FAR SIDE  
 0.590 (15) DIA. BOSS WITH M5 x 0.8mm THREADED BRASS INSERT (4) PLACES  
 0.590 (15) DIA. BOSS WITH 0.197 (5) DIA. HOLE x 0.395 (10) DEEP (6) PLACES

**INDUSTRY STANDARDS:**  
 UL508 TYPE 1, 2, 4, 4X INDOOR, 12 & 13  
 NEMA TYPE 1, 2, 4, 4X, 12 & 13  
 IEC529, IP66

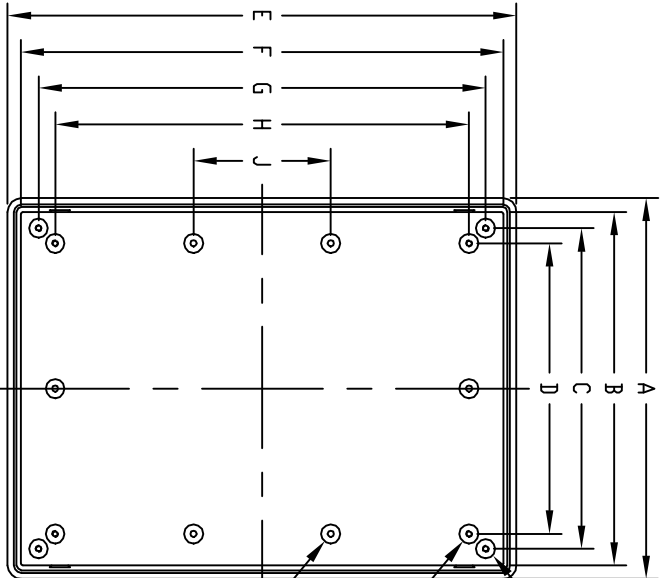

VIEW LESS COVER

DIMENSIONS = INCHES  
 [MILLIMETERS]

**NOTE:** ALL DIMENSIONS HAVE ±0.039 [±1] TOLERANCE UNLESS OTHERWISE SPECIFIED

PART NO.		DIMENSIONS														
SOLID COVER	CLEAR COVER	A	B	C	D	E	F	G	H	J	K	L	M	N	P	R
NBA-10148	NBA-10168	11.792 [300]	10.938 [278]	9.923 [252]	8.993 [228]	15.742 [400]	14.930 [379]	13.838 [351]	12.810 [325]	4.251 [108]	5.895 [150]	1.185 [30]	15.167 [385]	15.000 [381]	11.241 [286]	11.064 [281]